

Rabindra Nath Ghosh
 L.B.S. - Class - I No.- 1038
 Kolkata Municipal Corporation

Office:
 C-15, Baghajatin, Kolkata- 700092
 M.- 9433343630

SITE PLAN OF G+IV STORIED RESIDENTIAL BUILDING AT PREMISES NO. - 15A, RAIPUR MONDALPARA ROAD, UNDER THE K.M.C. WARD NO. - 100, BOROUGH NO. - X, KOLKATA - 700084.

AREA OF LAND = 06 KT.- 00 CH.- 00 SQ.FT. (401.338 SQ.M.) (AS PER DEED)
 AREA OF LAND = 394.211 SQ.M. (05 KT.- 14 CH.- 13.29 SQ.FT.) (PHYSICAL)

Reference points marked in the site Plan of the proposal	CO-ODINATE	
	Latitude	Longitude
a	22°-28'-38" (NORTH)	88°-22'-22" (EAST)
b	22°-28'-38" (NORTH)	88°-22'-22" (EAST)
c	22°-28'-37" (NORTH)	88°-22'-23" (EAST)
d	22°-28'-37" (NORTH)	88°-22'-23" (EAST)

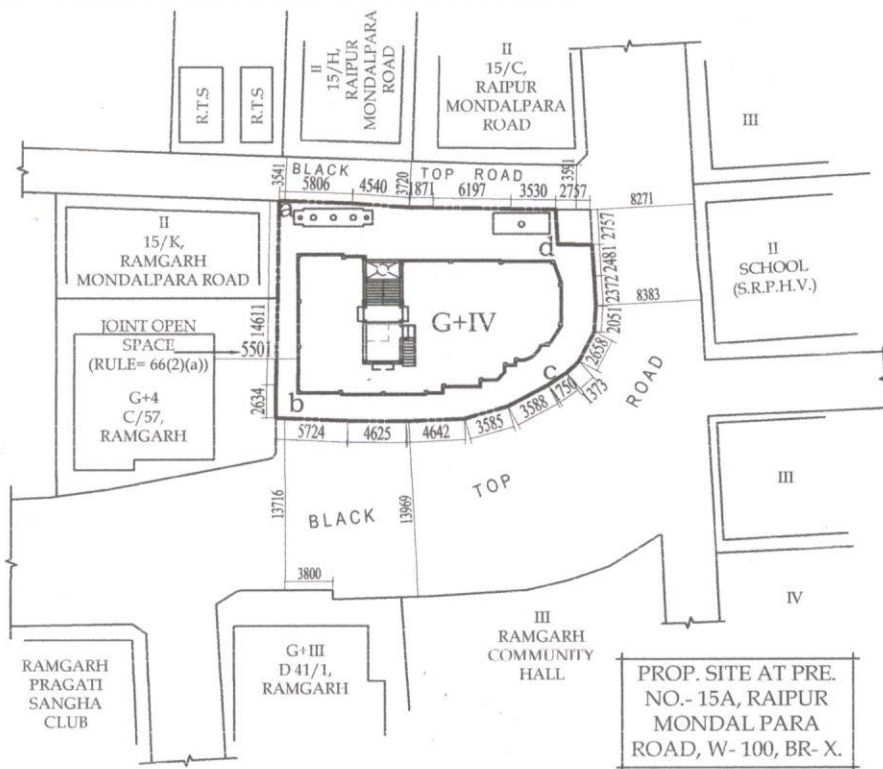

SITE PLAN
 (SCALE - 1 : 600)

M/S. SUVA DEEP CONSTRUCTION

[Signature]
 Partners

M/S. SUVA DEEP CONSTRUCTION

[Signature]
 Partners

[Signature]

RABINDRA NATH GHOSH
 LBS CI-1, NO-1038
 THE KOLKATA MUNICIPAL CORPORATION